



I.C.T. POWER COMPANY INC.
1220 Corporate Drive,
Burlington, Ontario L7L 5R6 Canada
Ph: 905-631-8494 Fax: 630-631-8495
www.ictpower.com sales@ictpower.com

UNIVERSAL STUD TORQUE INDICATOR

Match device stud size with appropriate hole size and read required torque setting, thread, and heat sink drill size.

TORQUE lb. - in.	STUD SIZE	DRILL SIZE
---------------------	--------------	---------------

360		49/64
-----	---	-------

.750 - 16

130		33/64
-----	---	-------

.500 - 20

120		13/32
-----	--	-------

.375 - 24

50		21/64
----	---	-------

.312 - 24

30		9/32
----	---	------

.250 - 28

20		7/32
----	---	------

.190 - 32

lb. - in.	Newtons
360	1614
130	583
120	538
50	224
30	134
20	90

DISC FORCE INDICATOR

Match device **pole face/contact area** with appropriate circle size and read required mounting force.

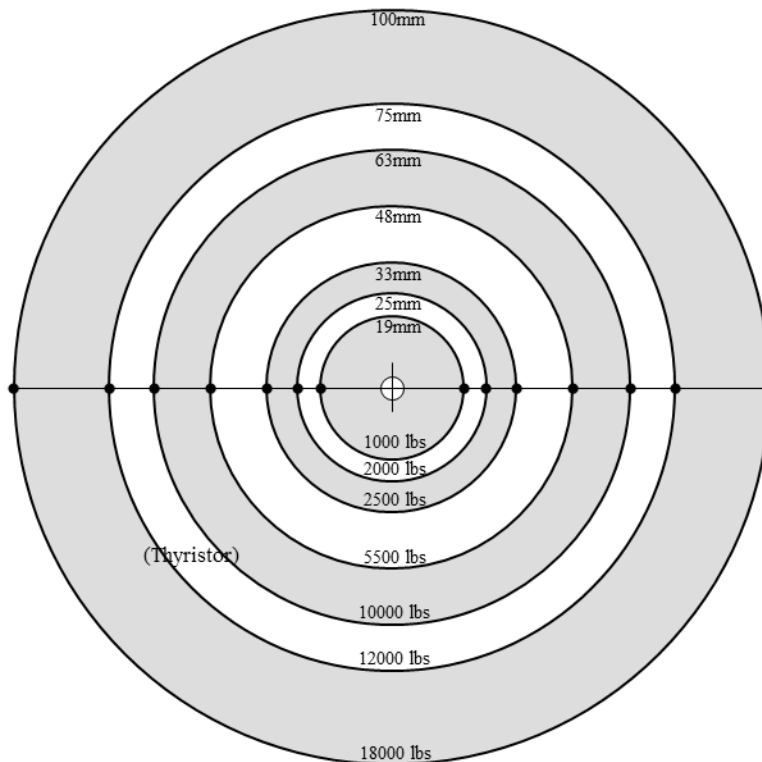

MOUNTING INSTRUCTIONS

- Clean and finish device and heat sink surfaces to 64 microns with 000 fine steel wool.
- Wipe surfaces with clean cloth and acetone.
- Apply thin film of G.E. Silica Oil to heat sink surface.
- If stud device, lightly coat threads with an anti-seize compound.
- Tighten to torque setting specified by this guide.
- If hockey puck device, refer to clamp manufacturer's guideline on reaching proper mounting force.
- Ensure heat sinks are exactly parallel and tighten bolts alternately ¼ turn at a time until pressure indicated on this guide, or device manufacturer's specification is reached.

(lbs)	PSI	KN	Kgf
1000	4	455	
2000	8	909	
2500	10	1136	
5500	22	2500	
10000	40	4545	
12000	48	5454	
18000	72	8181	

ALWAYS USE A CALIBRATED TORQUE WRENCH SUITABLE FOR THE SETTING SPECIFIED

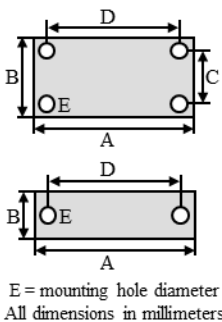

STANDARD / SCR AND DIODE MODULE PACKAGES

Package Size	A	B	C	D	E	Mounting Hardware Torque		Power Terminal Hardware Torque	
						Nm	lbf. in	Nm	lbf. in
20	92	20	-	80	5.8	4	35	4	35
25	92	25	-	80	5.5	4	35	4	35
34	94	34	-	80	6	6	53	12	106
50	92	50	38	80	6	6	53	12	106
60	124	60	48	112	6.5	6	53	12	106

DIODE

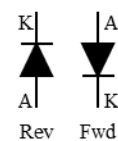

A = anode
K = cathode
G = gate

SCR

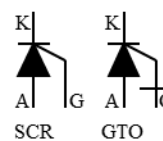

(thyristors)

REORDER PN: SPG04A-JB